

PERFIL eixo

COTAS TERRENO	27,09	25,74	25,23	25,08	25,29	25,65	26,48	27,67	29,13	30,27	31,17	31,38	30,02	28,05	27,14	26,83	27,06	26,63	25,40													
COTAS PROJETO	27,091	25,837	25,117	25,241	25,398	25,562	26,228	27,544	28,918	30,231	30,889	30,748	29,805	28,213	27,051	26,888	26,955	26,622	25,325													
ESTAQUEAMENTO	0	1	2	3	4	5	6	7	8	9	10	11	12	13	14	15	16	17	18													
PLANIMETRIA	TANGENTE L=18,253		R=220,000 D=30,415		TANGENTE L=29,632		R=220,000 D=17,296		TANGENTE L=52,388		R=220,000 D=26,842		TANGENTE L=29,209		R=5,000 D=8,441		TANGENTE L=18,211		R=80,000 D=11,834		TANGENTE L=20,036		R=120,000 D=18,591		TANGENTE L=14,582		R=50,000 D=7,029		TANGENTE L=12,470		TANGENTE L=43,076	

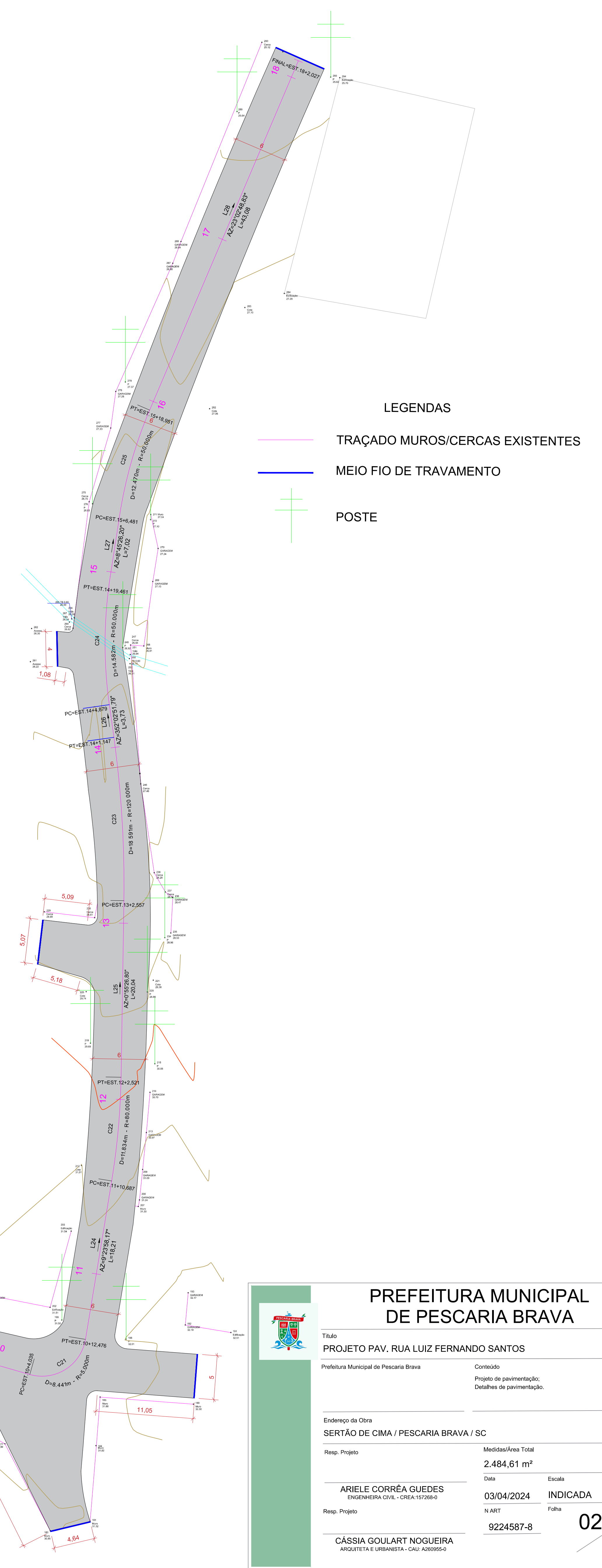

- LEGENDAS**
- TRAÇADO MUROS/CERCAS EXISTENTES
 - MEIO FIO DE TRAVAMENTO
 - POSTE

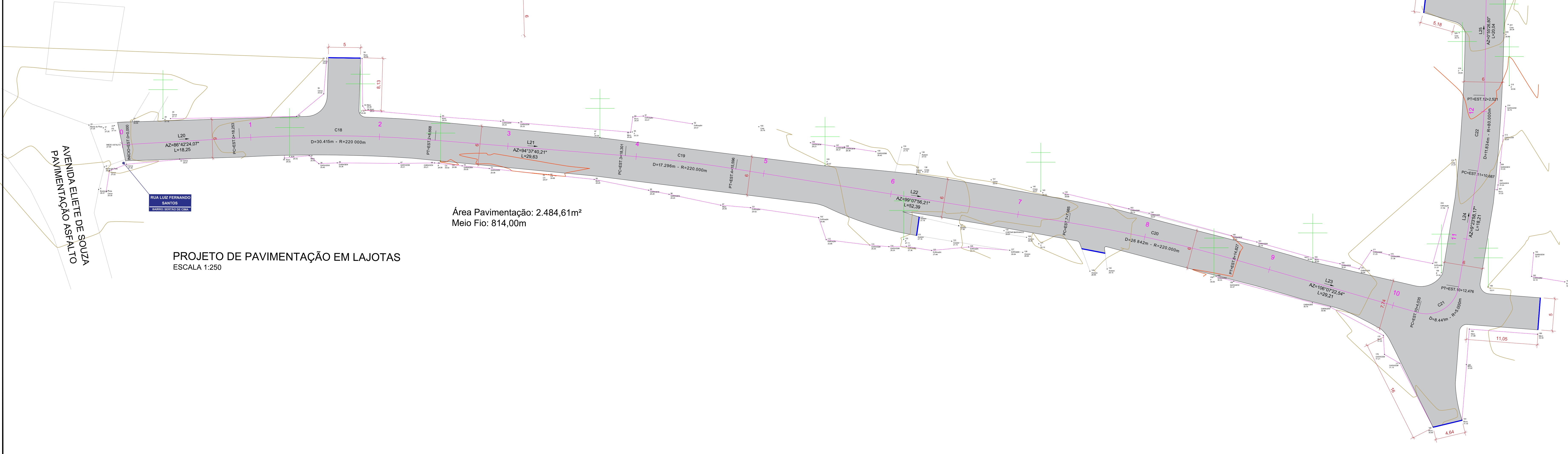
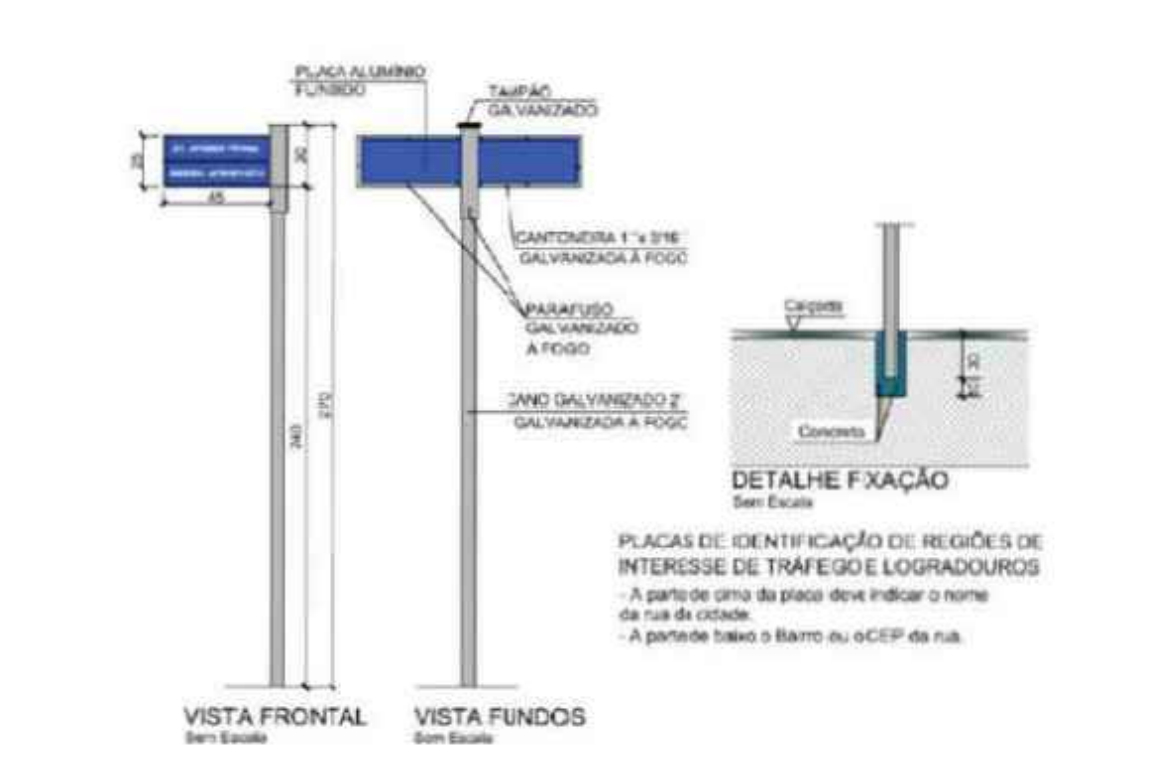
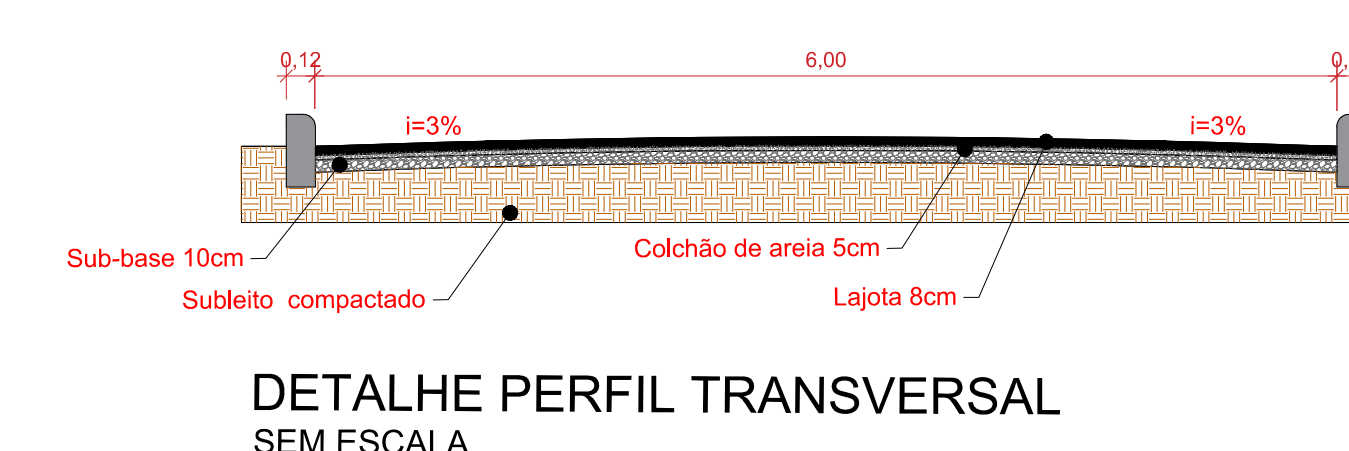
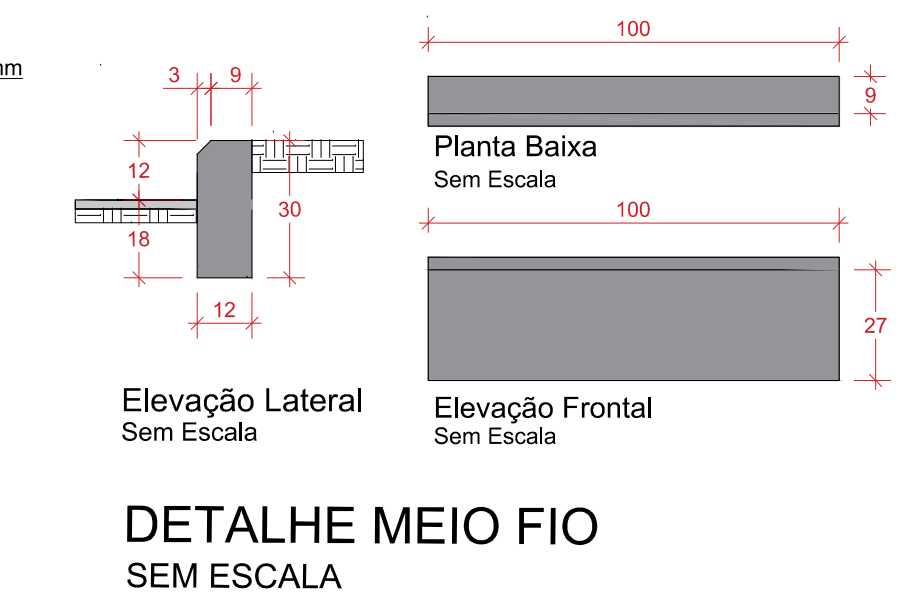
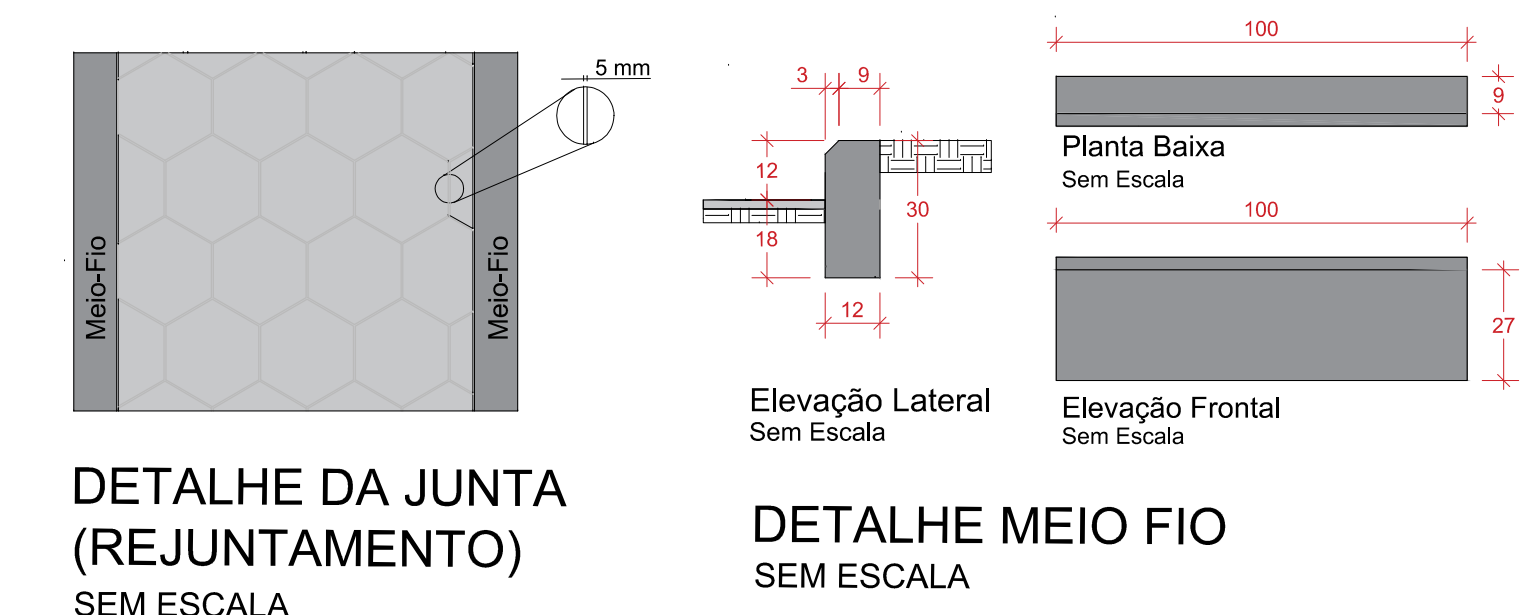
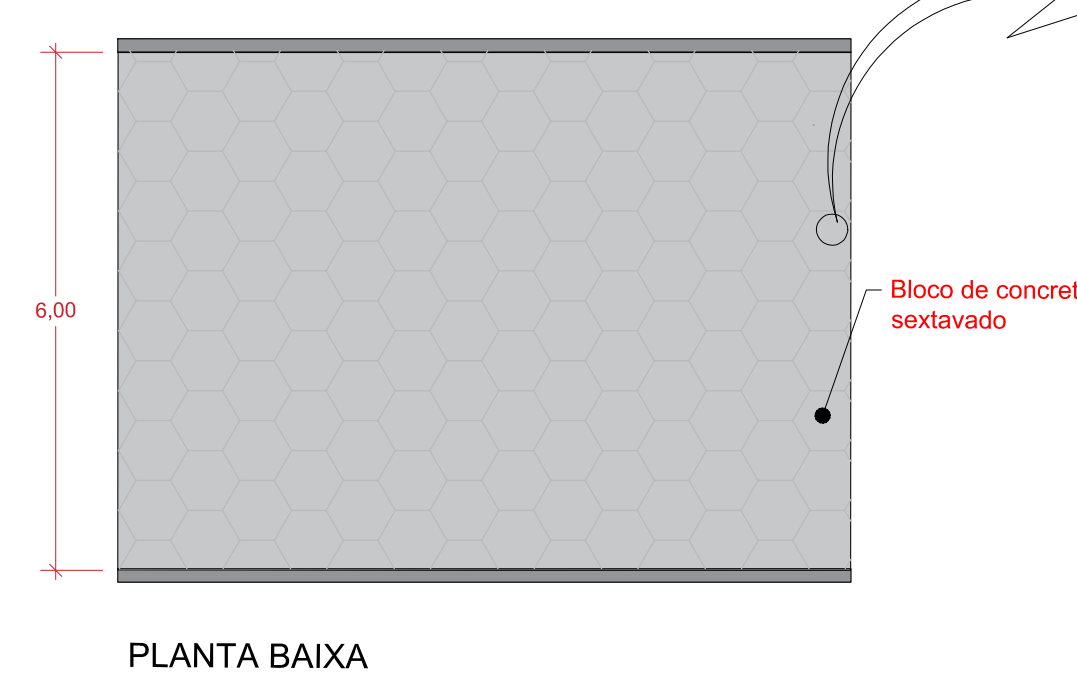

Área Pavimentação: 2.484,61m²
Meio Fio: 814,00m

PROJETO DE PAVIMENTAÇÃO EM LAJOTAS
ESCALA 1:250

PREFEITURA MUNICIPAL DE PESCARIA BRAVA

Título: PROJETO PAV. RUA LUIZ FERNANDO SANTOS

Endereço da Obra: SERTÃO DE CIMA / PESCARIA BRAVA / SC

Resp. Projeto: ARIELE CORRÊA GUEDES

Medidas/Área Total: 2.484,61 m²

Data: 03/04/2024

Escala: INDICADA

N.º ART: 9224587-8

Folha: 02

03